



Speedglas™
Welding Safety

PROLINE

professional welding supplies

3M™ Speedglas™ Welding Helmet G5-02

**World's first
curved auto-
darkening lens**

Ph: 0800 699 353
sales@prolinewelding.com

Your world is curved, not flat.

Introducing the 3M™ Speedglas™ Welding Helmet G5-02 with the world's first curved auto-darkening welding lens.

New 3M™ Speedglas™ Curved Glass Technology follows the shape of your head to maximise your natural range of vision.

Combining advanced True-View Technology with a 100% wider field of view, the G5-02 takes vision into a new dimension.

Curved Glass Technology



100% wider field of view



Advanced True-View Technology



Slimmer Lightweight Profile



3M
Speedglas™

ADVANCED ADF

Ph: 0800 699 353
sales@prolinewelding.com

'Ahead of the curve'.

Over 40 years ago, the Speedglas brand released the first ever auto-darkening welding helmet.

After 20 years of development, the launch of the 3M™ Speedglas™ Welding Helmet G5-02 marks another world first - 3M™ Speedglas™ Curved Glass Technology.

Designed specifically for TIG welders, the G5-02 helmet creates a new world standard for precision viewing. This is a helmet for professional TIG welders wanting to stay 'ahead of the curve' doing high-performance, critical work.

The latest, high-end, inverter-based TIG machines offer incredibly stable arcs. With our most advanced electronics ever, the G5-02 welding lens reliably switches even at very low TIG settings.

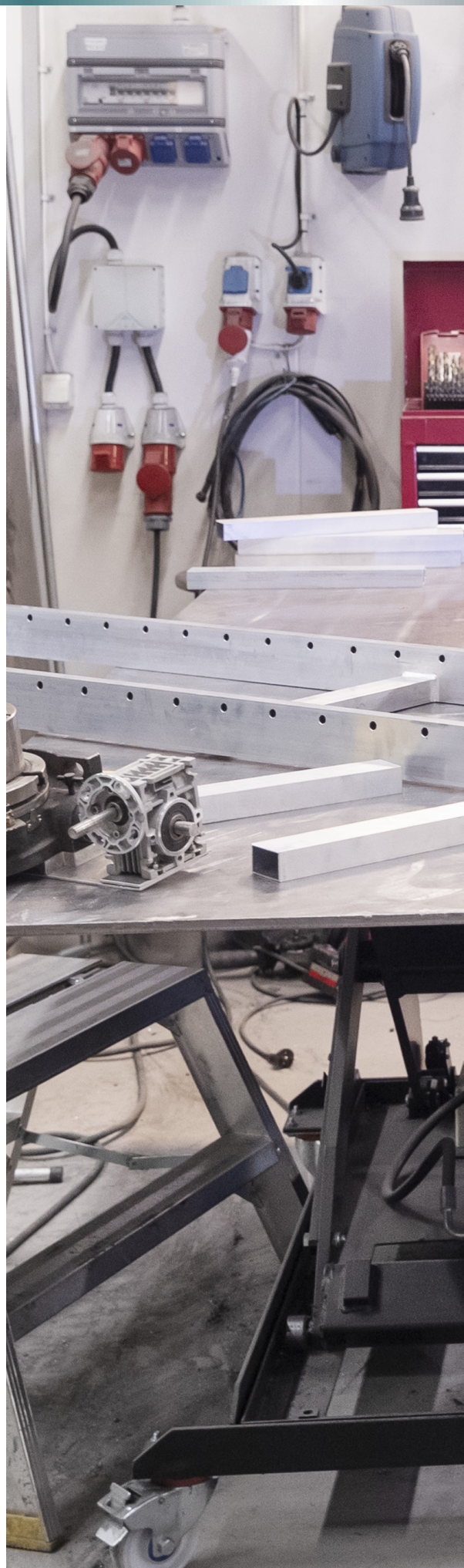



Ph: 0800 699 353
sales@prolinewelding.com

Why curved?

Feedback from professional TIG welders was unanimous; a wide view was much higher rated than a taller view.

The only way to achieve wider views without making the helmet wider was by inventing a curved welding lens.

Curved
Glass
Technology.

150mm

2:1 aspect ratio

Our previous largest Speedglas ADL

3M™ Speedglas™ Curved ADL G5-02

100% wider
field of view.

Ph: 0800 699 353
sales@prolinewelding.com

Get wider views in a slimmer, lighter helmet.

Previously, you had to compromise: either a slim, lightweight helmet or a wide view. With the curved G5-02 welding lens, there are no compromises.

A thinner glass pack makes the helmet super lightweight and bringing the lens closer to the welder's face improves overall weight distribution.

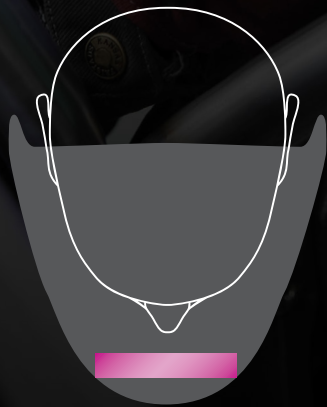

A flat lens in a slim helmet means the lens can't be wide.



Expanded field of view with a flat lens requires a wider helmet.

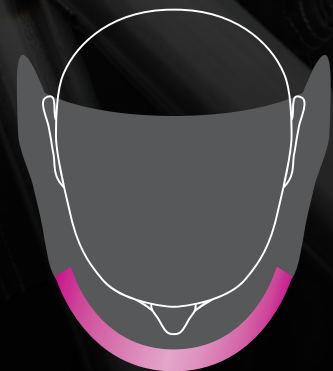

A curved lens gives you a wider total field of view in a slim helmet.



Reduce reflection and stale air.

The combination of the curved welding lens and a slimmer helmet can help reduce reflections and other distracting glare inside the welding helmet.

A new exhaled air venting system reduces heat and humidity inside the welding helmet.

Ph: 0800 699 353
sales@prolinewelding.com

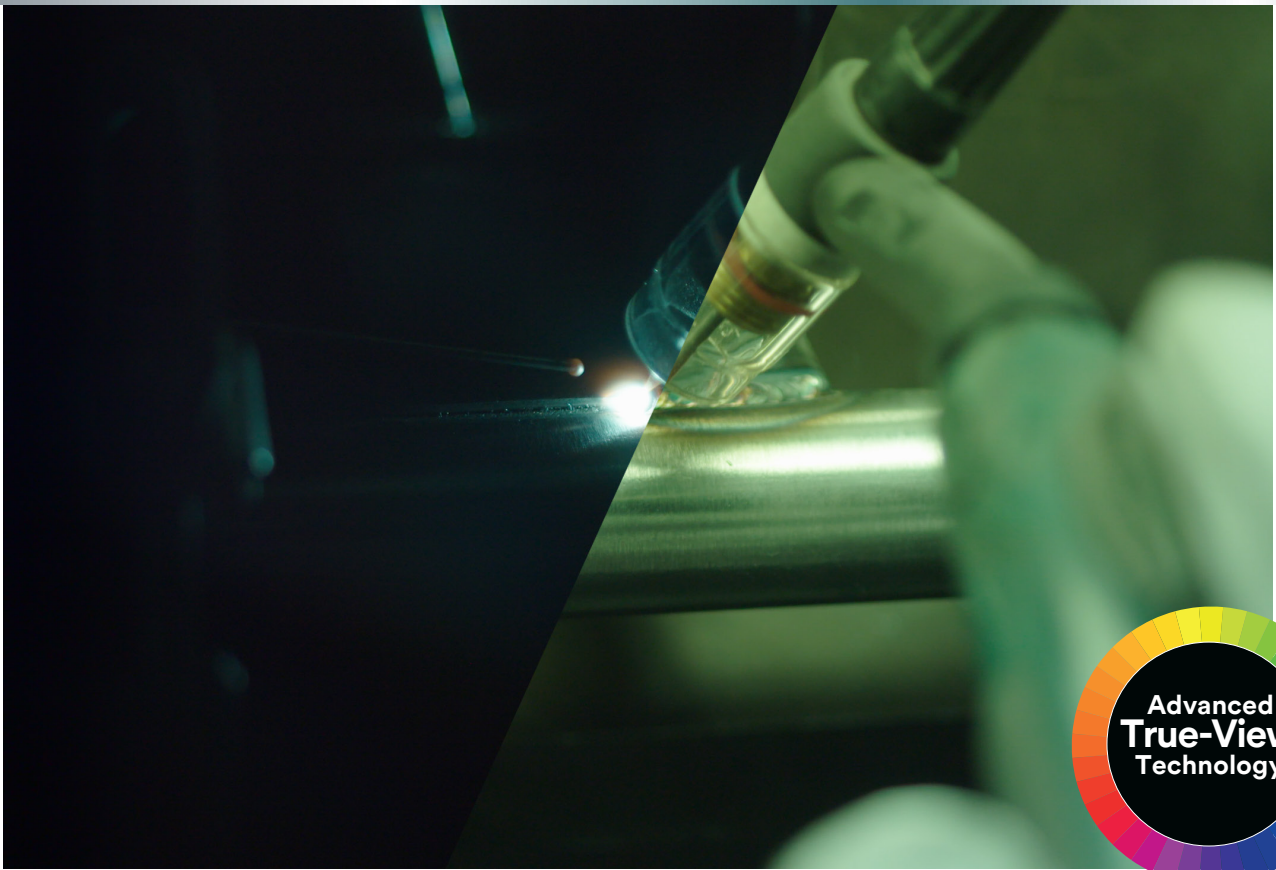

A view like no other.

With our clearest light state ever, curved vision and advanced 3M™ Speedglas™ True-View technology the G5-02 optics must be experienced to be believed. Colours appear brighter and more realistic in both the light and dark states. And a more realistic view enables better control over your arc.



Designed to be more intuitive, you'll love our new control panel: controls are located on both sides of your viewing area.

The most frequently used controls (SHADE and SENSITIVITY) are in the most accessible locations: the lower left and right corners.

Ph: 0800 699 353
sales@prolinewelding.com



The curved lens is manufactured in Sweden under clean room conditions using one-of-a-kind, custom-engineered machines.



3M™ Speedglas™ Curved Glass Technology.

“We’ve been working on a curved lens for more than two decades,” says Stefan Henriksson, 3M Welding Eye & Face Product Manager.

“We tested – and rejected – curved lenses made with plastic substrates. We have found that plastic has low heat resistance and is permeable, absorbing contaminants that reduce filter visibility and longevity. Of all the materials we tested, curved glass outperformed them all.”

Is the curved glass more fragile than flat glass?

The glass we use in the G5-02 lens is extremely flexible. And the lens is certified using the same, standardised impact resistance tests used for traditional flat welding lenses: The welding lens and protection plate are compliant with AS/NZS1337.1, meaning resistance to high speed particles up to 45m/s (medium impact rated).

More importantly, you're benefitting from our finest optics ever, due in part to a "glass pack" that's 1/3 as thick as our thinnest flat lens.

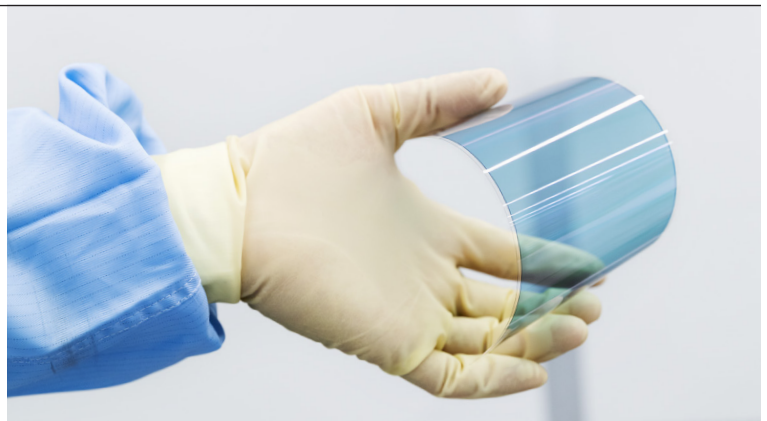

Auto darkening
lens G5-02
62 00 20

Inner protection
plate
62 40 00

Magnifying lens
17 20 20, 17 20 21,
or 17 20 22

Curved consumables for the curved lens.

For a slimmer helmet, we created consumables to optimise the view and comfort.

If you can't see the detail you need, try one of our magnifying lenses. For the G5-02 helmet they are curved (of course) and available in x1.5, x2.0 and x2.5 strengths.



Technical specifications

3M™ Speedglas™ Welding Helmet G5-02

3M™ Speedglas™ Curved Glass Technology	Yes
3M™ Speedglas™ Advanced TrueView Technology	Yes
Switching time, dark-light	50–1000 ms
Switching time, light-dark	0.1 ms (+23° C)
Dark state	Shade 8–12
Light state	Shade 2.5
UV/IR Protection (permanent)	Shade 12
Viewing area, (approx.)	150 × 76 mm
Weight, helmet including welding lens	535 grams
Auto ON	Yes
Bluetooth™ for 3M Connected Equipment App	Yes
Battery lifetime (hours)	1500
Number of sensors (arc detection)	4



To find reusable and disposable 3M™ Respirators that fit under the G5-02 helmet, please visit www.awsi.com.au

Ph: 0800 699 353
sales@prolinewelding.com



Ready to experience the curved lens?

Be one of the first to experience 3M™ Speedglas™ Curved Glass Technology, order a complete helmet:



3M™ Speedglas™ Welding Helmet G5-02

Including curved welding lens, headband, cleaning wipe and storage bag.

Part No 62 11 20

Parts list

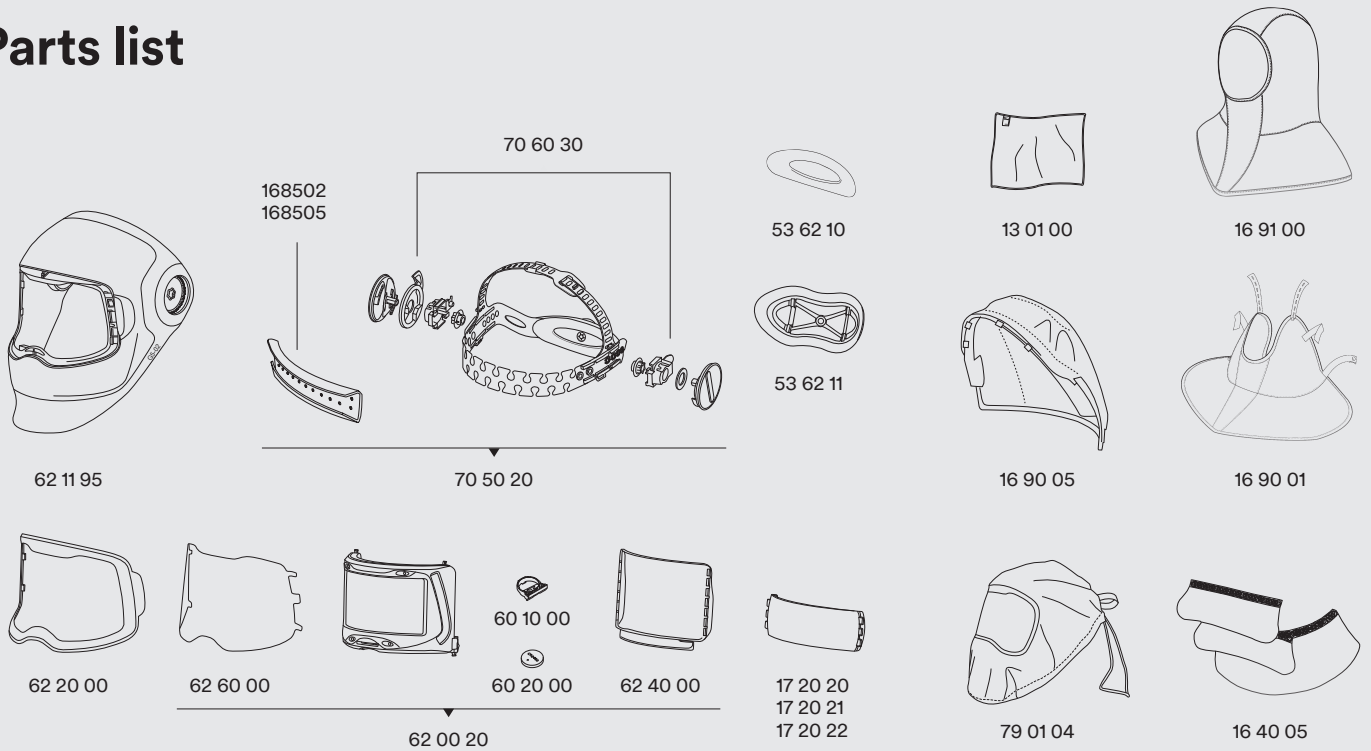

Part No	Description	Part No	Description	Part No	Description
13 01 00	3M Cleaning Wipe	53 62 11	Head Harness Back Cushion (Large)	62 40 00	Lens Cover Inner Pk=2
16 40 05	Ear/Throat Protection Leather	60 10 00	Battery Holder	62 60 00	Lens Cover Outer Hard Coated Pk=5
16 85 02	Sweatband Pk=2	60 20 00	Battery CR2450	70 50 20	Head Harness G5-02
16 85 05	Sweatband Pk=5	62 00 20	Speedglas Curved Welding Lens G5-02	70 60 30	Head Harness Pivot Mechanisms
16 90 01	Throat Protection Tecaweld	62 11 20	Helmet G5-02 with Welding Lens, Head Harness, Cleaning Wipe and Bag	79 01 04	Helmet Storage Bag G5-02
16 90 05	Head Protection	62 11 95	Helmet Exc Welding Lens, Head Harness & Front Cover		
16 91 00	Head Cape Tecaweld	62 20 00	Front Cover		
17 20 20	Magnifying Lens 1.5X				
17 20 21	Magnifying Lens 2.0X				
17 20 22	Magnifying Lens 2.5X				
53 62 10	Head Harness Back Cushion (Small)				